

A Project By



# AASHRAY

3 BHK Luxurious Flats



Site Address : Plot No. 11, Anupam Society, Near Gurukul Vidya Mandir, Friends Colony, Nagpur.

AASHRAY  
3 BHK Luxurious Flats

DAY VIEW





## PARKING VIEW

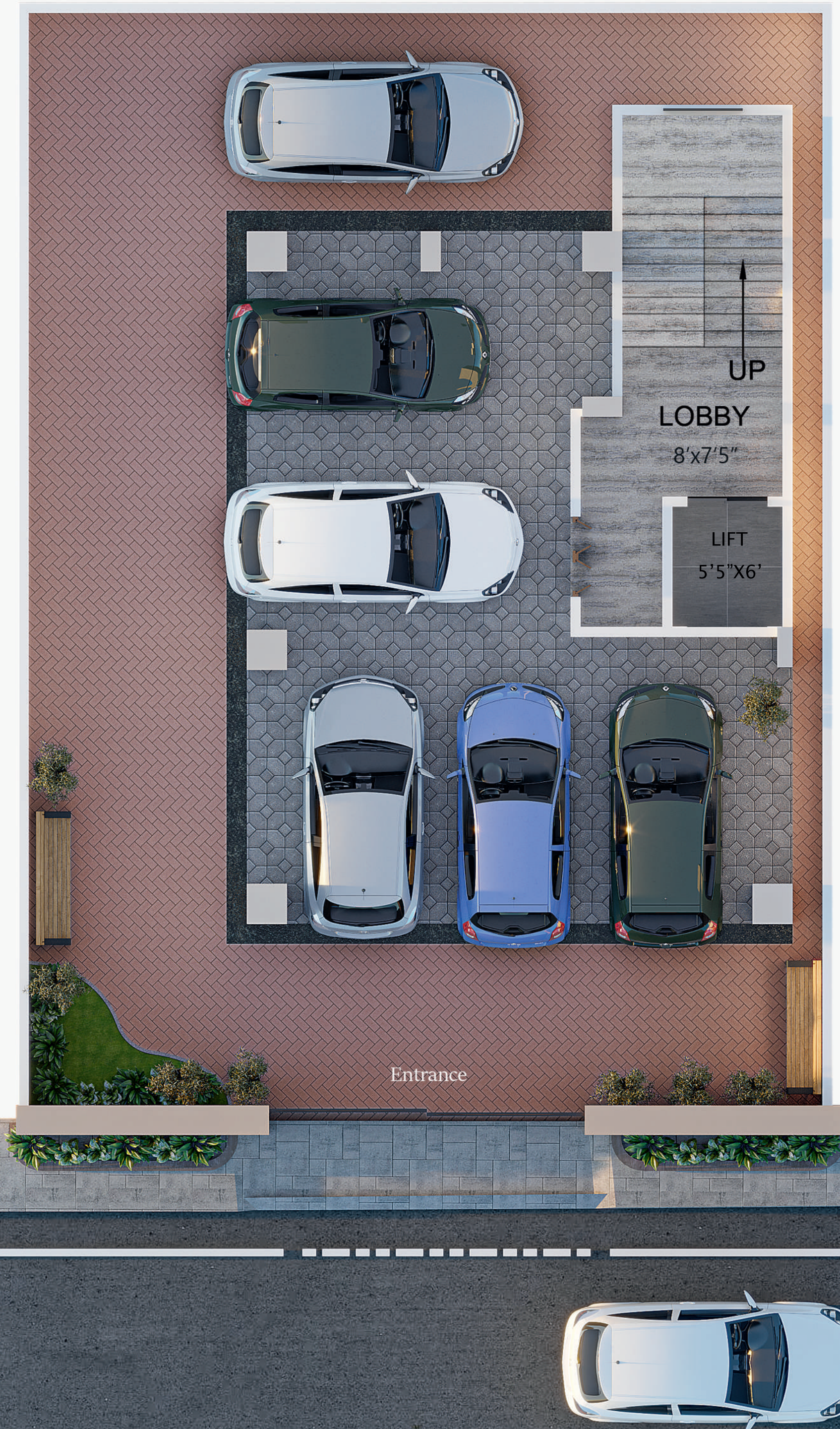

**TYPICAL 1st TO 6th FLOOR PLAN**



**SUPER B/UP AREA=151.527 SQ.MT. (1630.43 SQ.MT.)**

ISOMETRIC VIEW  
3 BHK PLAN

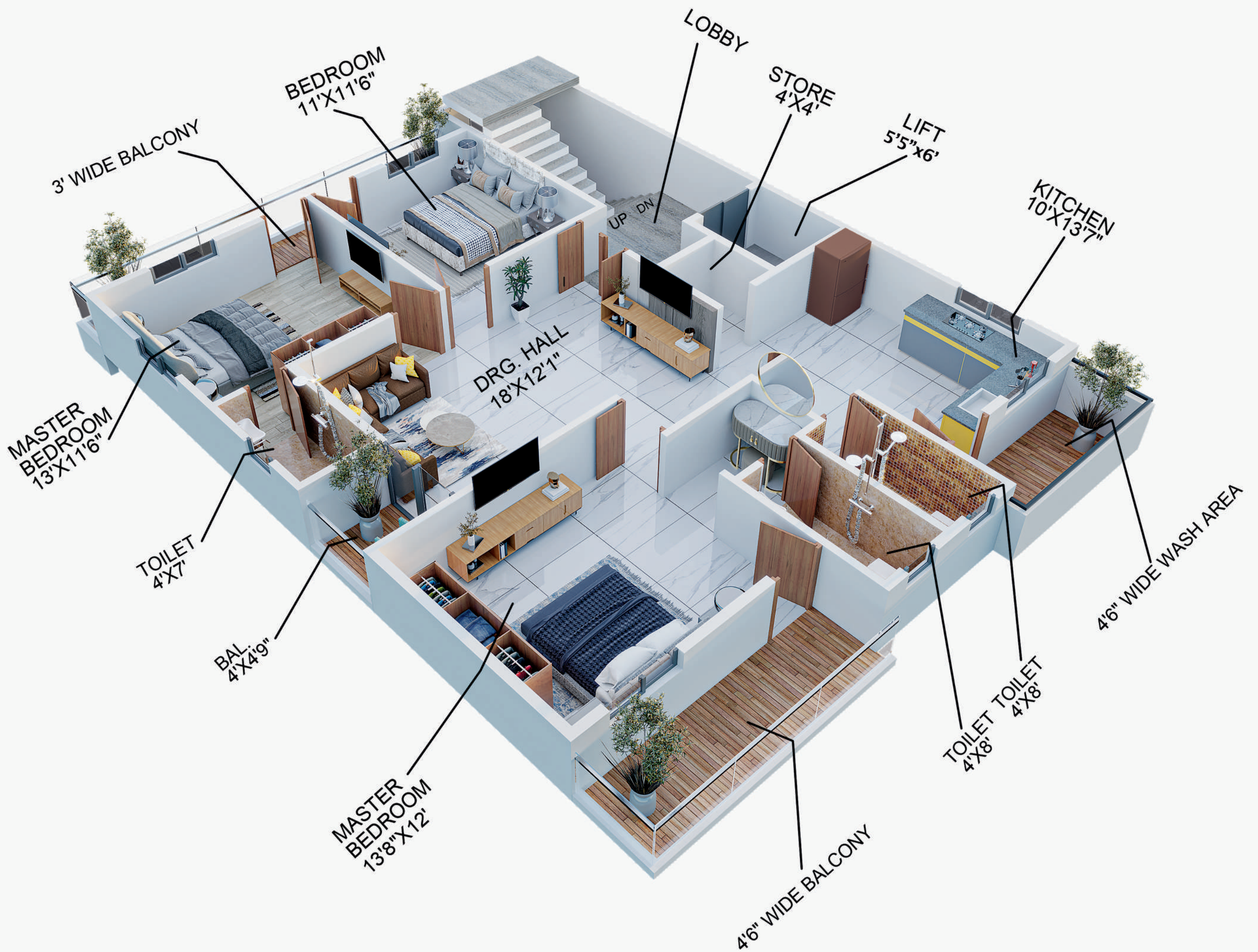

# SPECIFICATIONS

# AASHRAY

3 BHK Luxurious Flats

## AMENITIES



## SPECIFICATIONS

- STRUCTURE**
  - Earth-quake resistant, RCC framed structure
- WALLS**
  - Internal : 115mm thick Brick Wall
  - External : 150mm thick Brick Wall
- DOORS & WINDOWS**
  - Main Door - Decorative veneer laminated door & Frame
  - Inner Door - Decorative laminated door & Frame
  - Toilet Door - Laminated flush door
  - Windows - UPVC windows/M.S. safety grill
- RAILING**
  - SS Railing with Toughened glass in Balcony
  - SS Railing in staircase
- PLUMBING**
  - Jaguar /Cera or Equivalent concealed fittings and fixtures
- ELECTRICAL**
  - All electrical wiring Anchor/ Havells is concealed and of Branded and modular switches
  - Sufficient power outlet and light points provided
  - A/C Point in Hall & All Bed Rooms

- BATHROOM**
  - Anti skid Ceramic tiles
  - Washbasin
  - Premium fittings and premium sanitary ware
  - Designer dado up to full Height
  - Hot & Cold water connection
- BED ROOM & LIVING**
  - Vitrified Tiles flooring 2'X4' in all room
  - Cable TV connection in Hall
- PARKING**
  - Ample two wheeler parking
- KITCHEN**
  - Granite Platform Top with dado up to Lintel height & Premium brand SS Sink
- PAINTING**
  - External - Weather Protective Paint with 2 coat water proof Primer
  - Internal - Plastic paint with full putty
- LIFT**
  - Premium brand Lift (6 Passengers Capacity )

- WATER SUPPLY**
  - Overhead Water Tank
  - Underground Water Tank,Borewell, Corporation Water Supply.

- PARKING & COMMON AREAS**
  - One dedicated Car Parking Space for Each Flat.
  - Paver Blocks in Margin Space.

- facility**
  - CCTV Surveillance For Common areas
  - Rain Water Harvesting
  - Solar Panels For Common area .
  - False Ceiling In All Rooms.

- PURCHASER HAS TO PAY FOLLOWING SEPRATELY**
  - Stamp Duty & Registration Fees.
  - M.S.E.B. Meter Charges & Water Meter Charges.
  - G.S.T. Or Any Others Taxes Will Be Extra Charged, Possession Of The Flat Will Be Given By Builder After Clearance Of All Dues.
  - Any Extra Additional Work Shall Be Charged Separately In Advance..

AASHRAY  
3 BHK Luxurious Flats

NIGHT VIEW



# LOCATION MAP

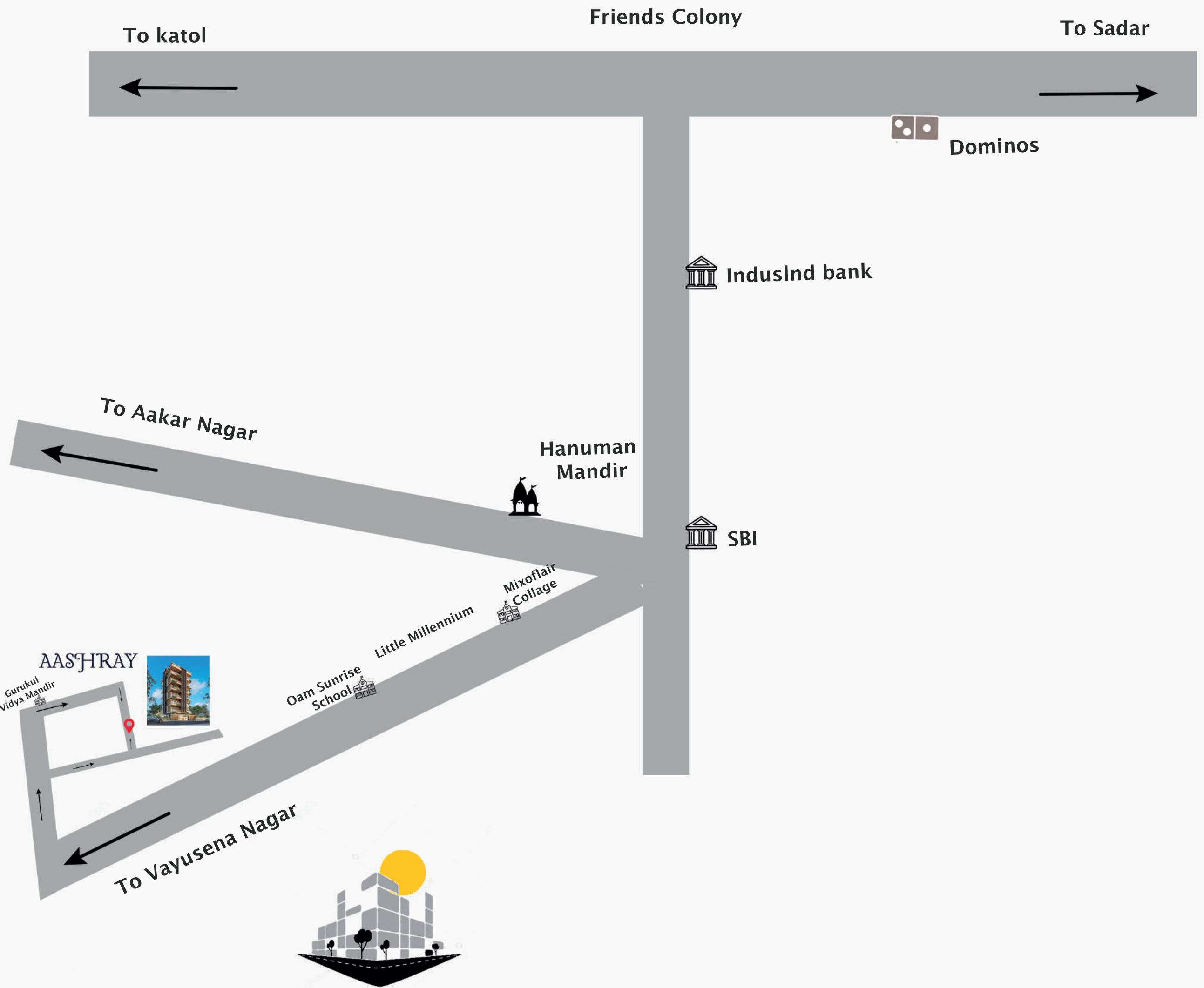

A Project By  
**SHUKAR INFRA**

FINANCE AVAILABLE



BOOKING CONTACT

**9322087069**

**Site Address : Plot No. 11, Anupam Society, Near Gurukul Vidya Mandir, Friends Colony, Nagpur.**

ARCHITECT

A & S ASSOCIATES

STRUCTURAL ENGINEER

AASHISH SONI

LEGAL ADVISOR

SANDIP SONTAKKE